

C13 - LATTE STOOL

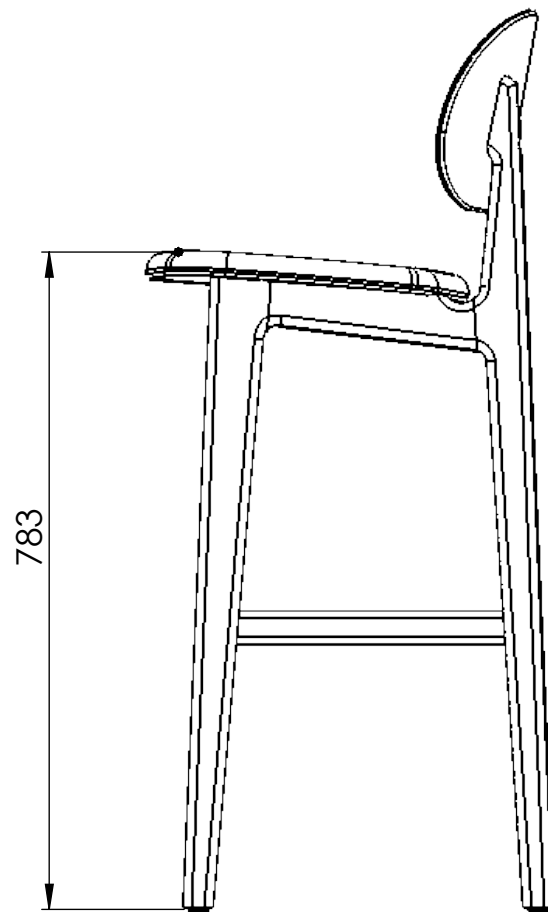

UPHOLSTERED SHAPED PLYWOOD SEAT - 25MM V33H CMHR FOAM UPHOLSTERED ON A PRESS

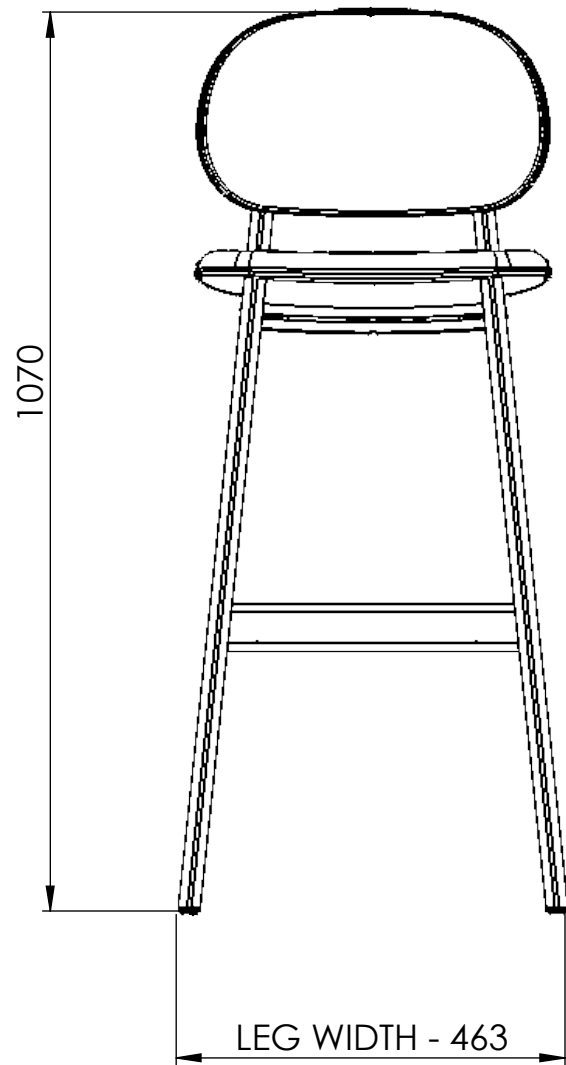
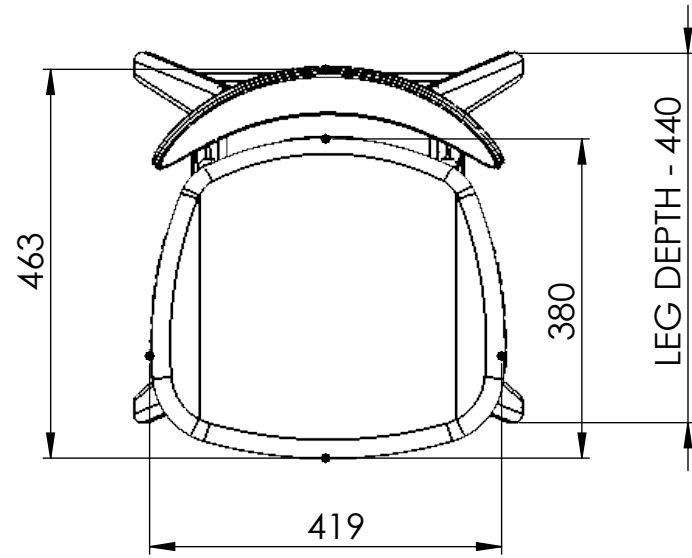
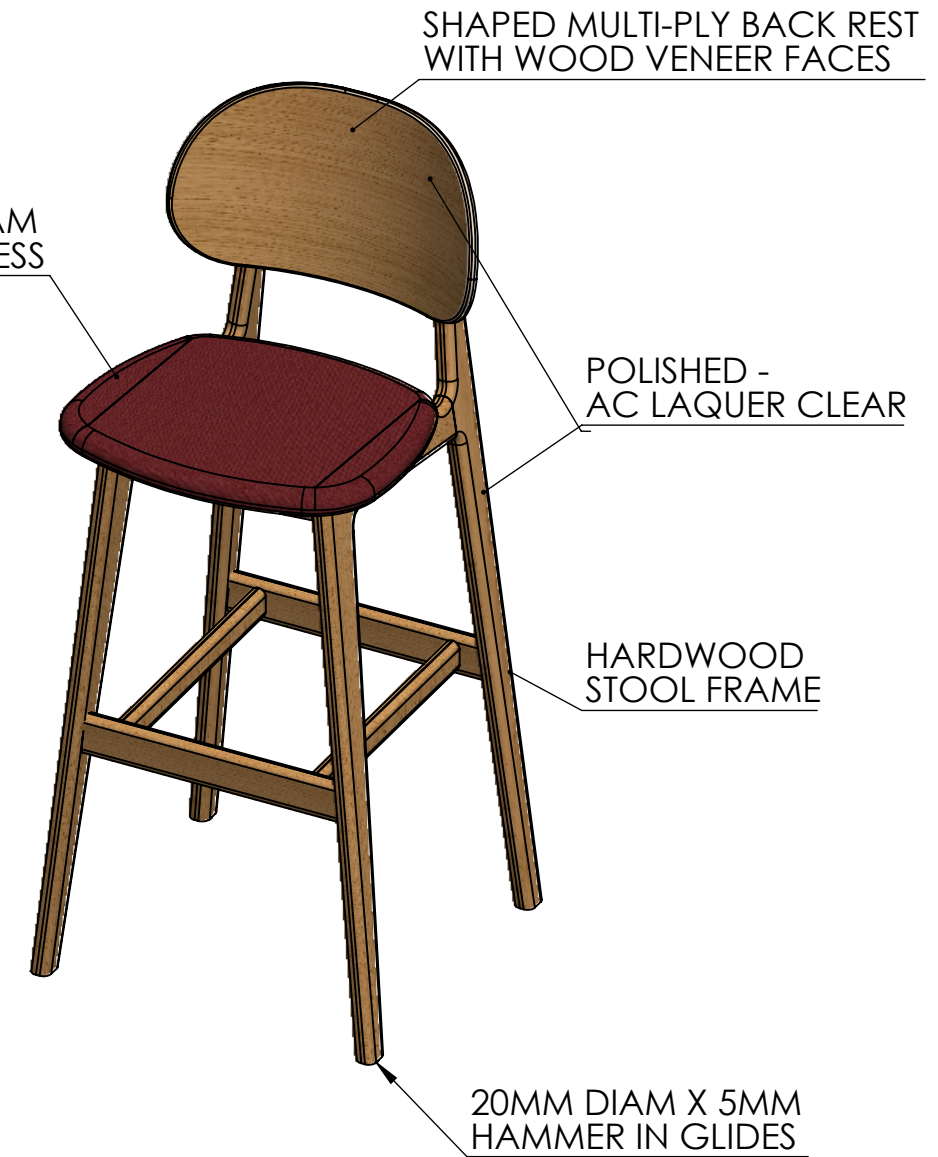

C13 - LATTE STOOL RAW

20MM DIAM HOLES
FOR AIR RELEASE

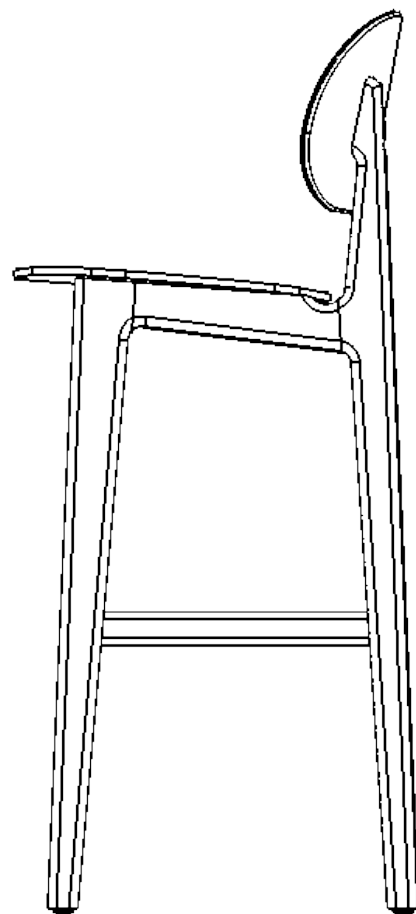
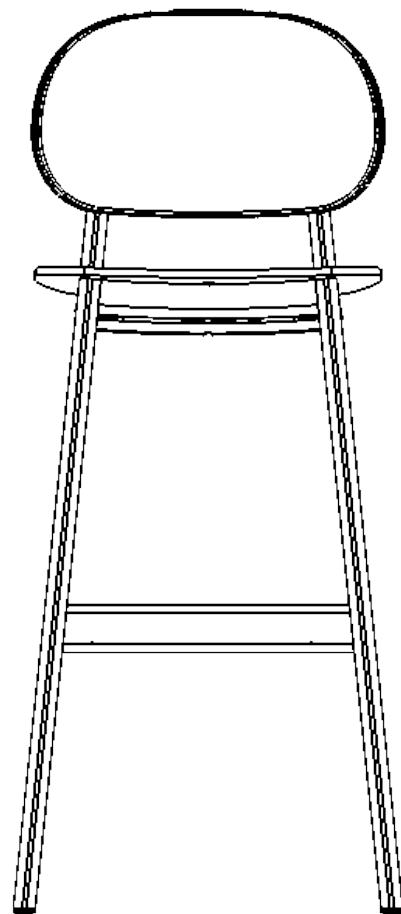
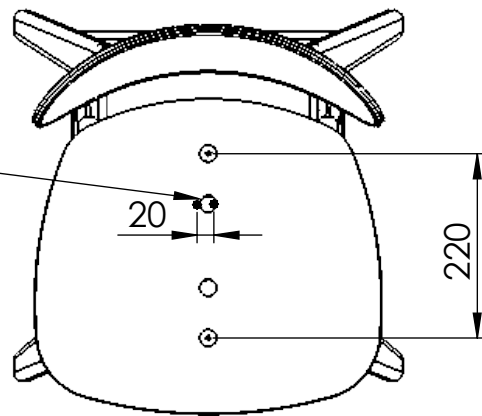

M6 TEE NUT FOR BOLT
FIXING THROUGH FRAME

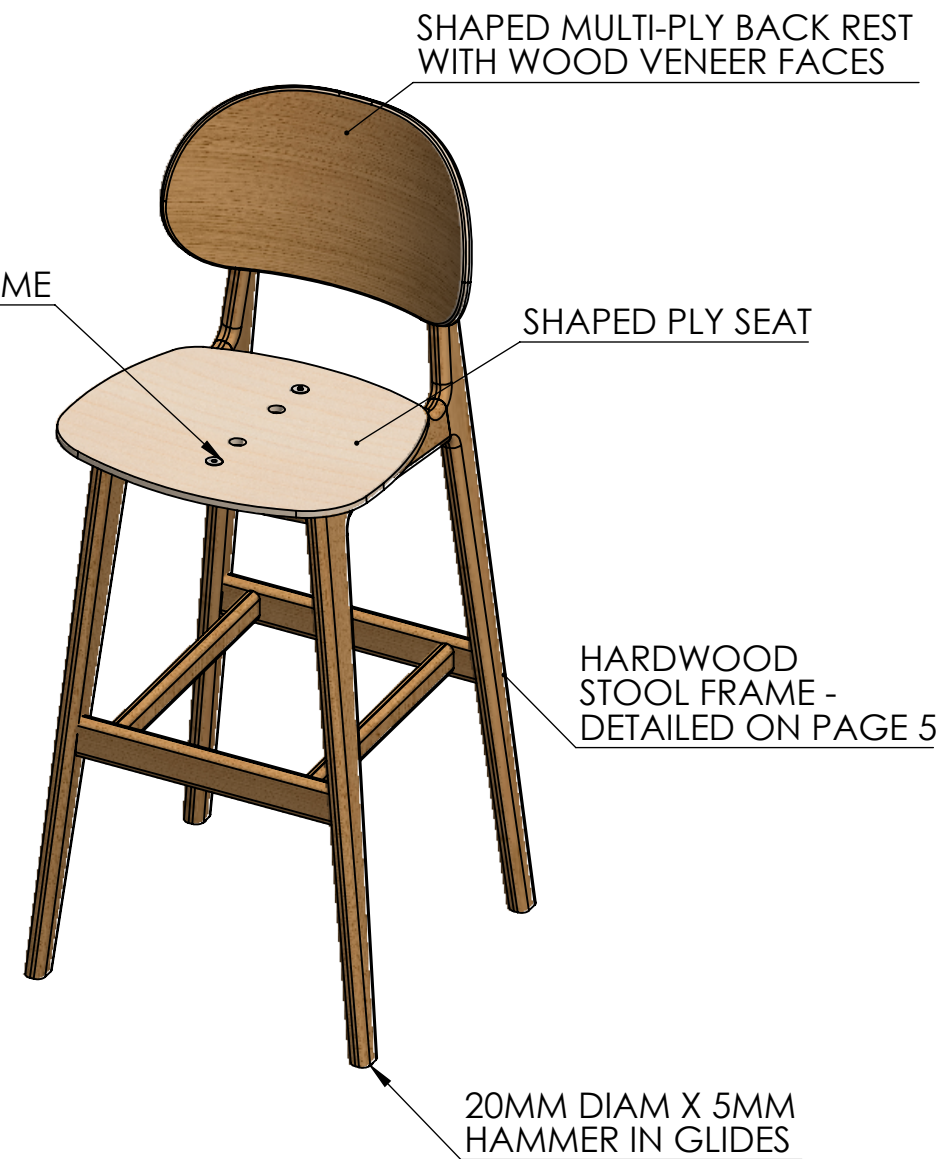

SHAPED MULTI-PLY BACK REST
WITH WOOD VENEER FACES

SHAPED PLY SEAT

HARDWOOD
STOOL FRAME -
DETAILED ON PAGE 5

20MM DIAM X 5MM
HAMMER IN GLIDES

C13 - LATTE STOOL COMPONENTS

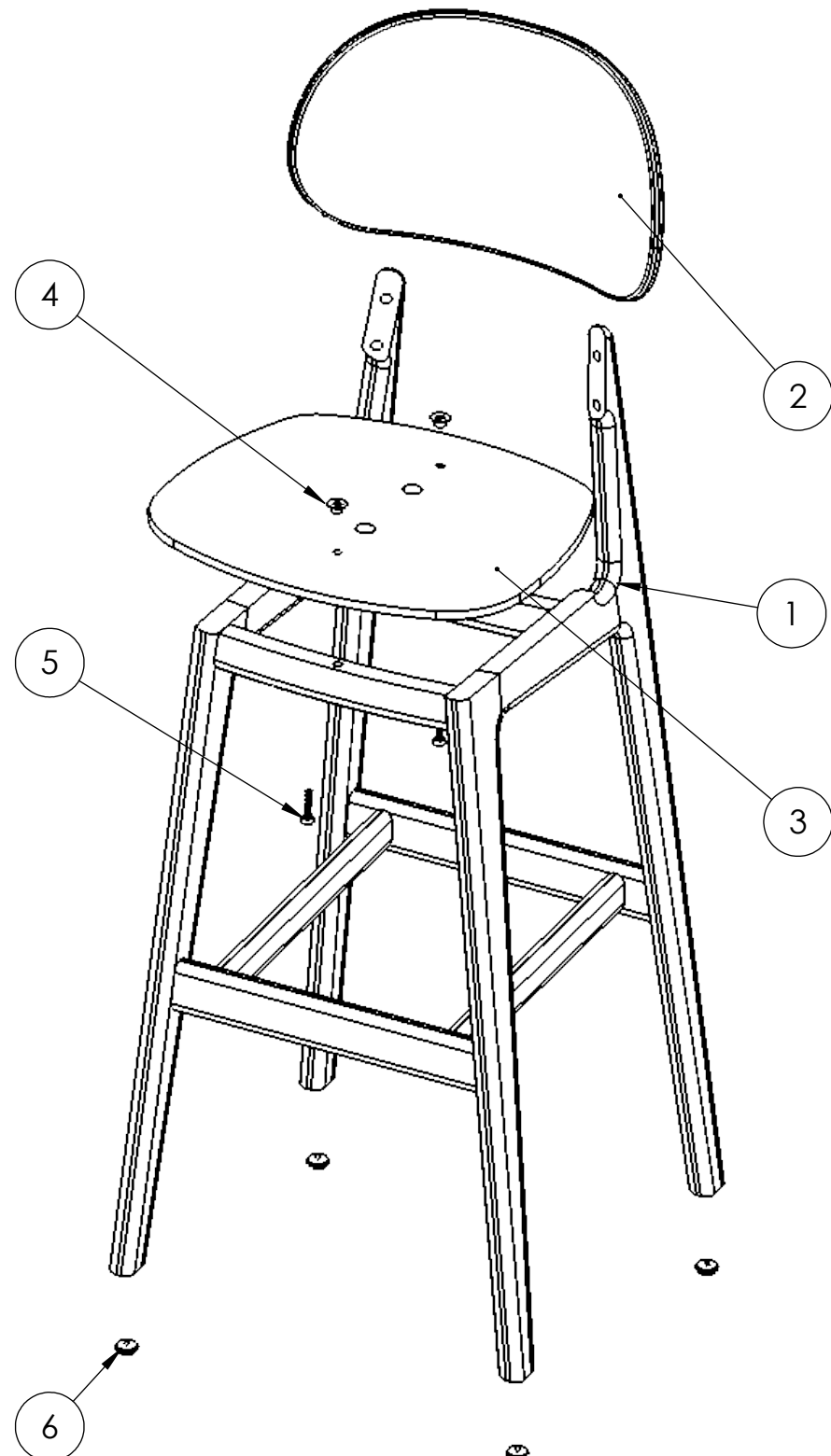

ITEM	QUANTITY	SIZE	NOTES
1 - CHAIR FRAME	1	SEE PAGES 5 - 8 FOR DETAILS	HARDWOOD
2 - BACK REST	1	SEE NEXT PAGE FOR DETAILS	SHAPED MULTI-PLY WITH WOOD VENEER FACES
3 - SEAT BOARD	1	SEE NEXT PAGE FOR DETAILS	12MM SHAPED PLYWOOD
4 - M6 TEE NUTS	2	M6	STEEL
5 - M6 20MM HEX BOLT	2	M6 X 20MM	HEX BOLT
6 - 20MM DIAM X 5MM HAMMER IN GLIDES	4	20MM DIAM X 5MM	PLASTIC FOOT GLIDE

C13 - LATTE STOOL BACK REST

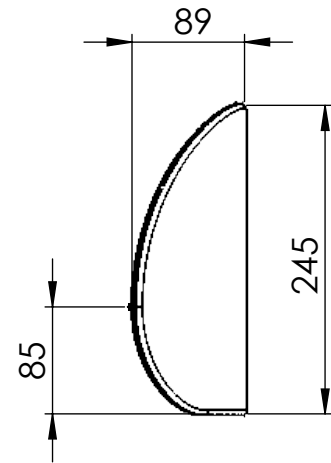
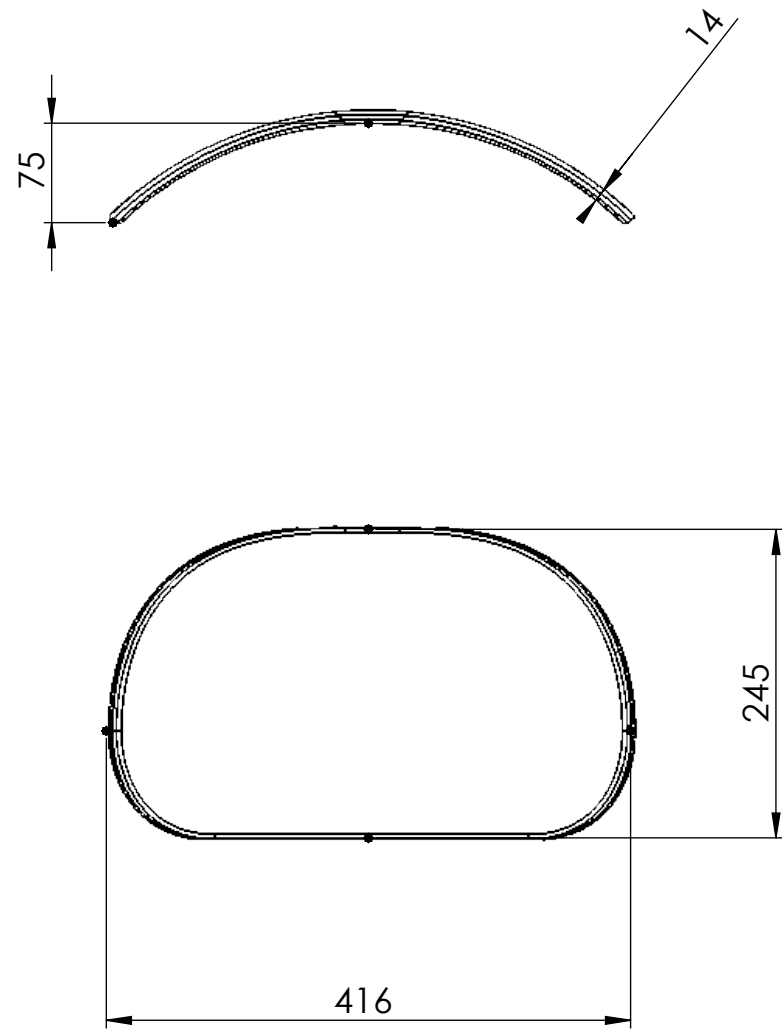

**FIXED IN PLACE THROUGH BACK LEGS
SEE NEXT PAGE**

C13 - LATTE STOOL SEAT BOARD

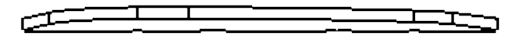
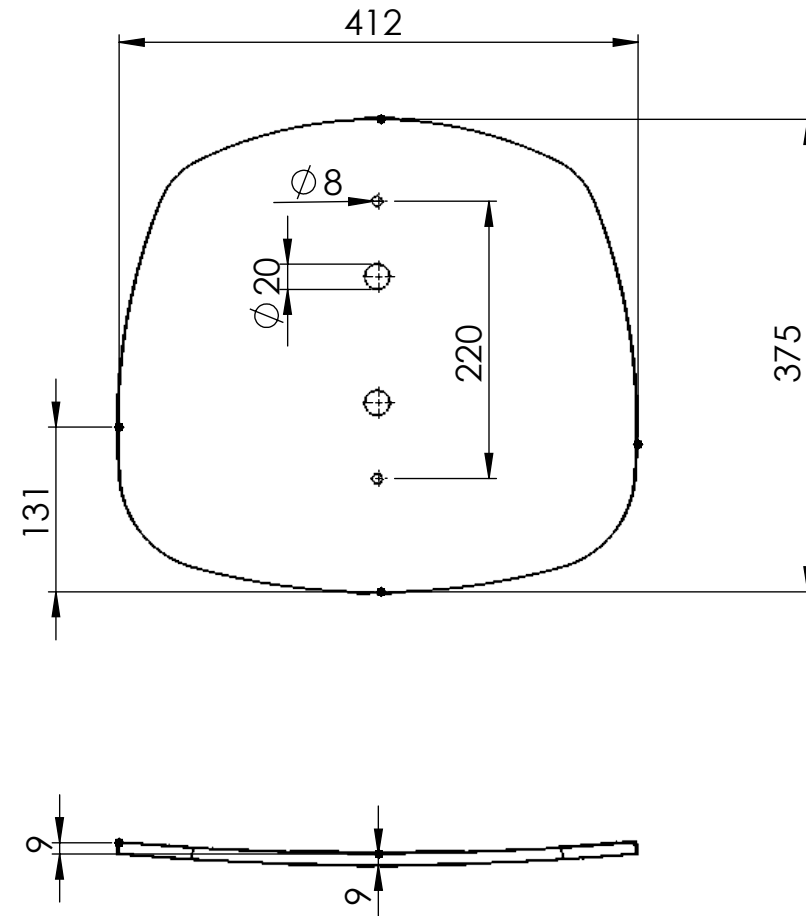

C13 - LATTE STOOL FRAME

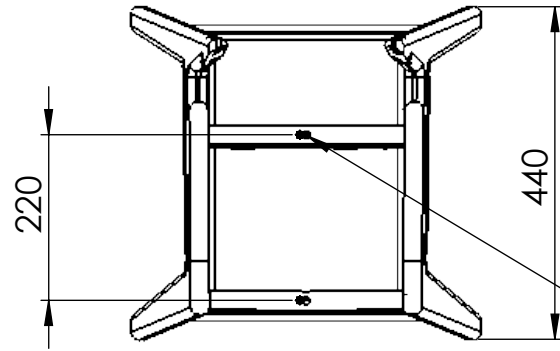

10MM DIAM HOLES SPACED TO FIT SEAT BOARD

ALL JOINTS ARE MORTISE & TENON

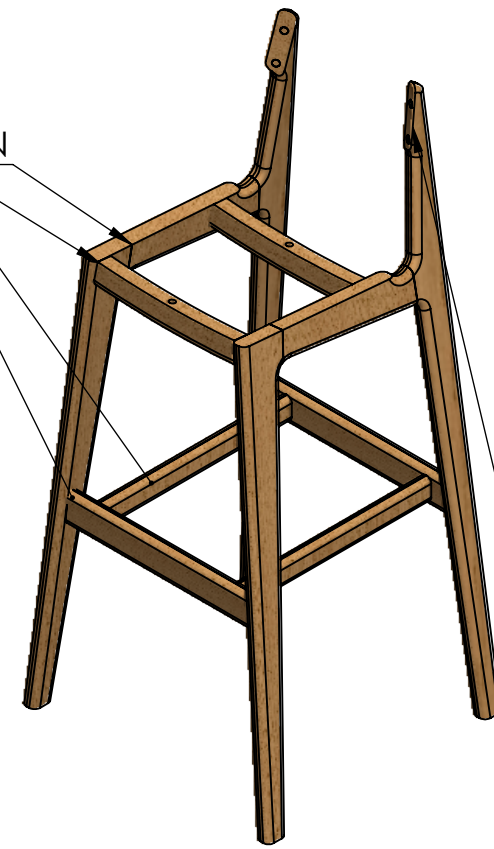

BACK SCREWED THROUGH LEG & PLUGGED USING MATCHING HARDWOOD

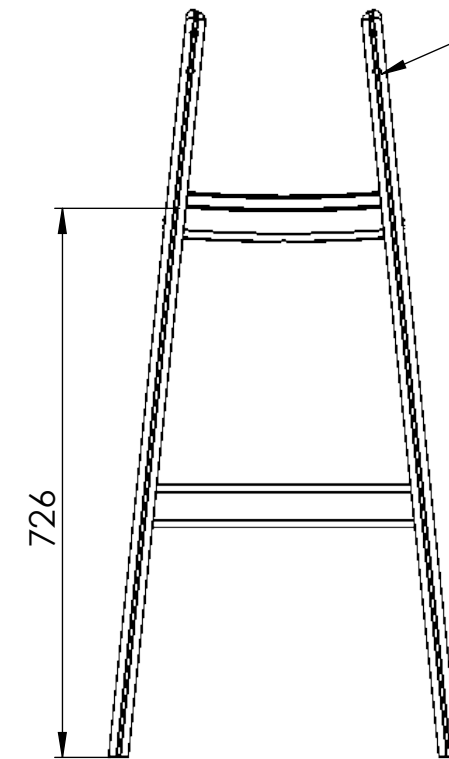
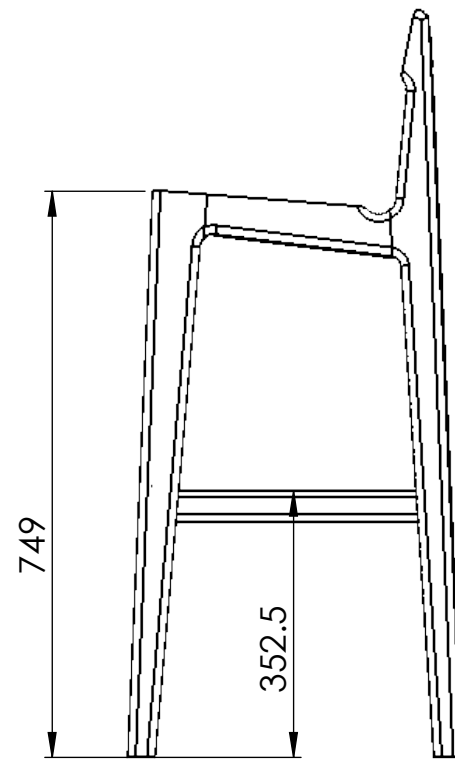
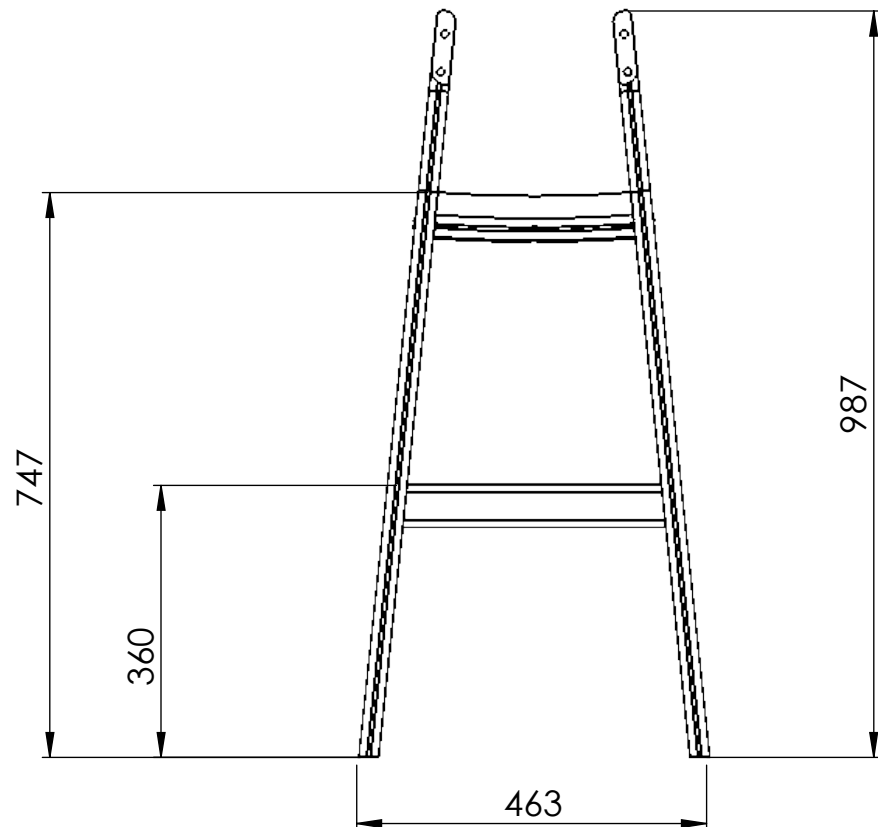

C13 - LATTE STOOL FRAME COMPONENTS

ITEM	QUANTITY	SIZE	NOTES
1 - LEGS	2 (FLIPPED)	SEE NEXT PAGE	HARDWOOD - JOINED BEFORE ASSEMBLING FRAME
2 - WIDTH RAILS	2	SEE PAGE 8 FOR DETAILS	HARDWOOD
3 - DEPTH RAILS	2	SEE BELOW FOR SIZES	HARDWOOD
4 - FRONT SEAT RAIL	1	SEE PAGE 8 FOR DETAILS	HARDWOOD
5 - BACK SEAT RAIL	1	SEE PAGE 8 FOR DETAILS	HARDWOOD

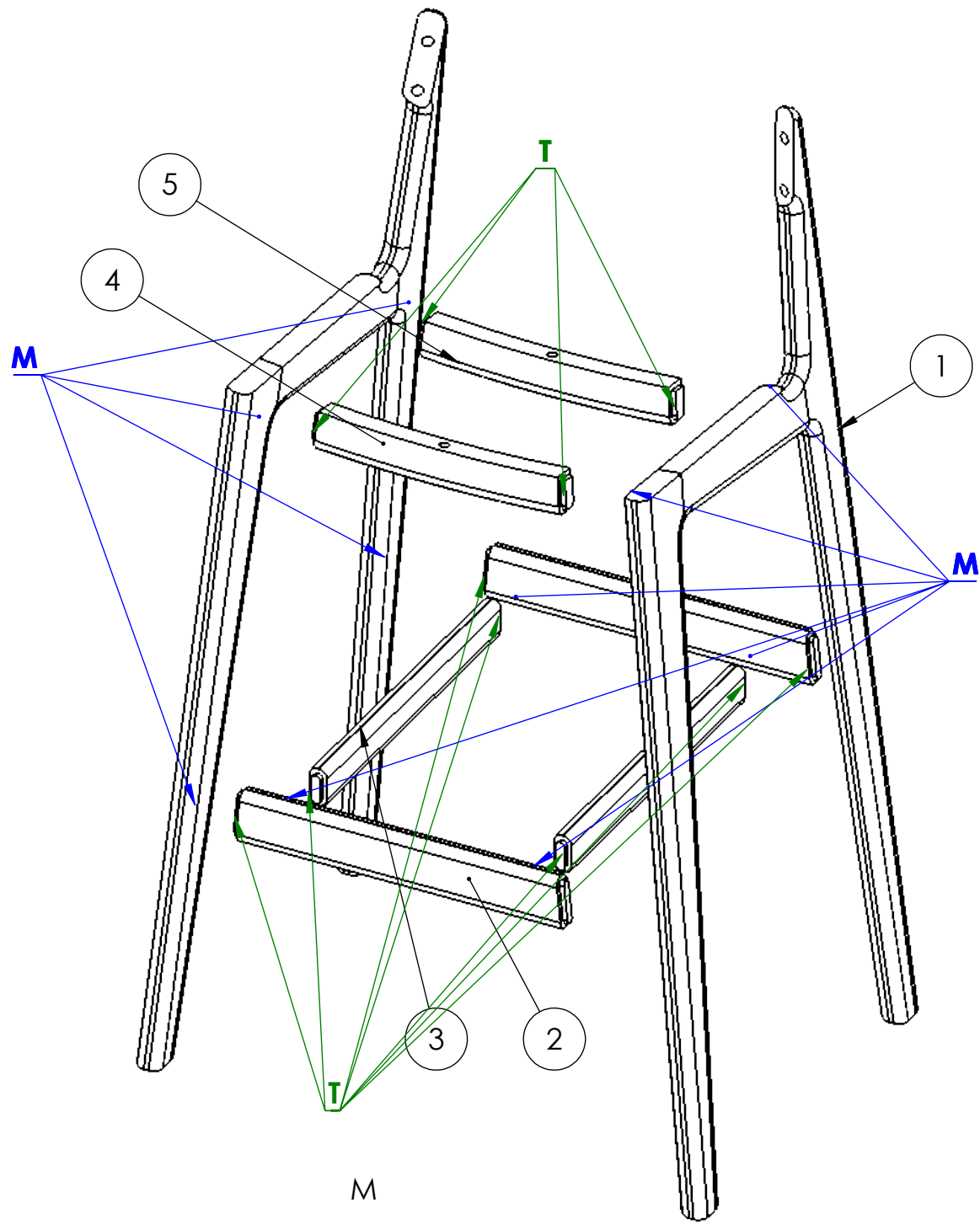

ITEM 3 - SCALE 1:3

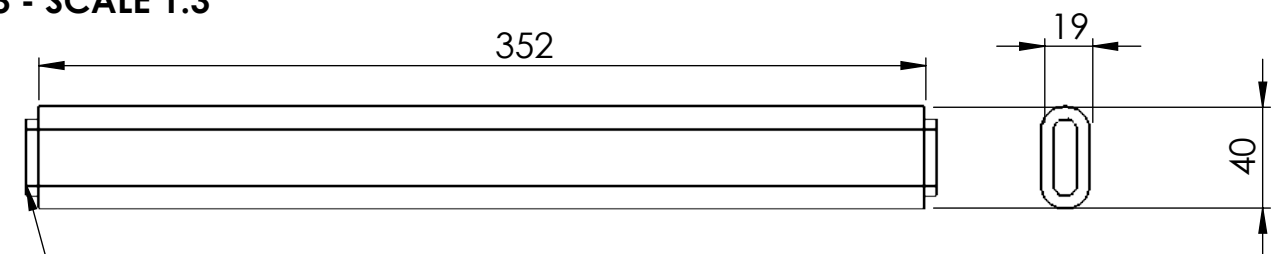

MORTISE AND TENON BASED ON MACHINE CAPABILITY

ALL MORTISE AND TENON JOINTS TO BE GLUED
 - M = MORTISE
 - T = TENON

C13 - LATTE STOOL LEGS

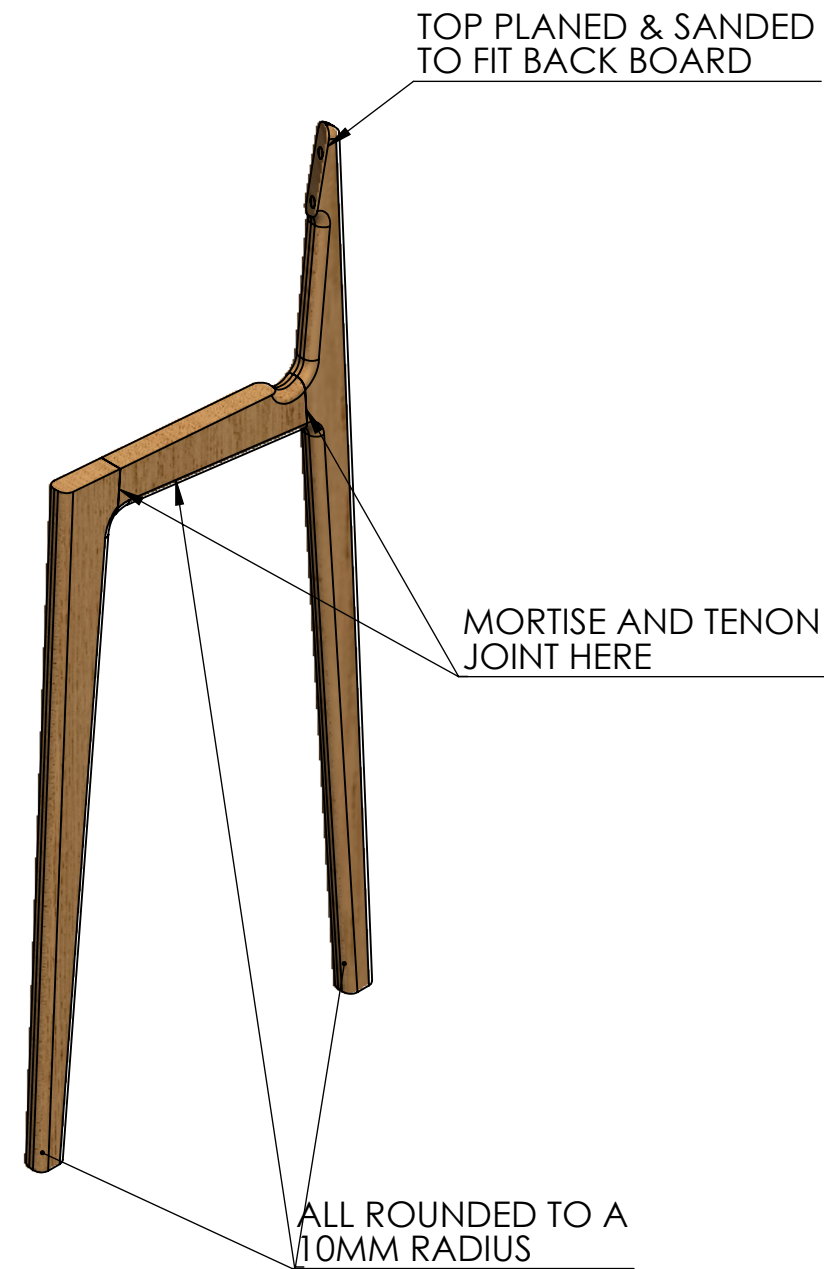
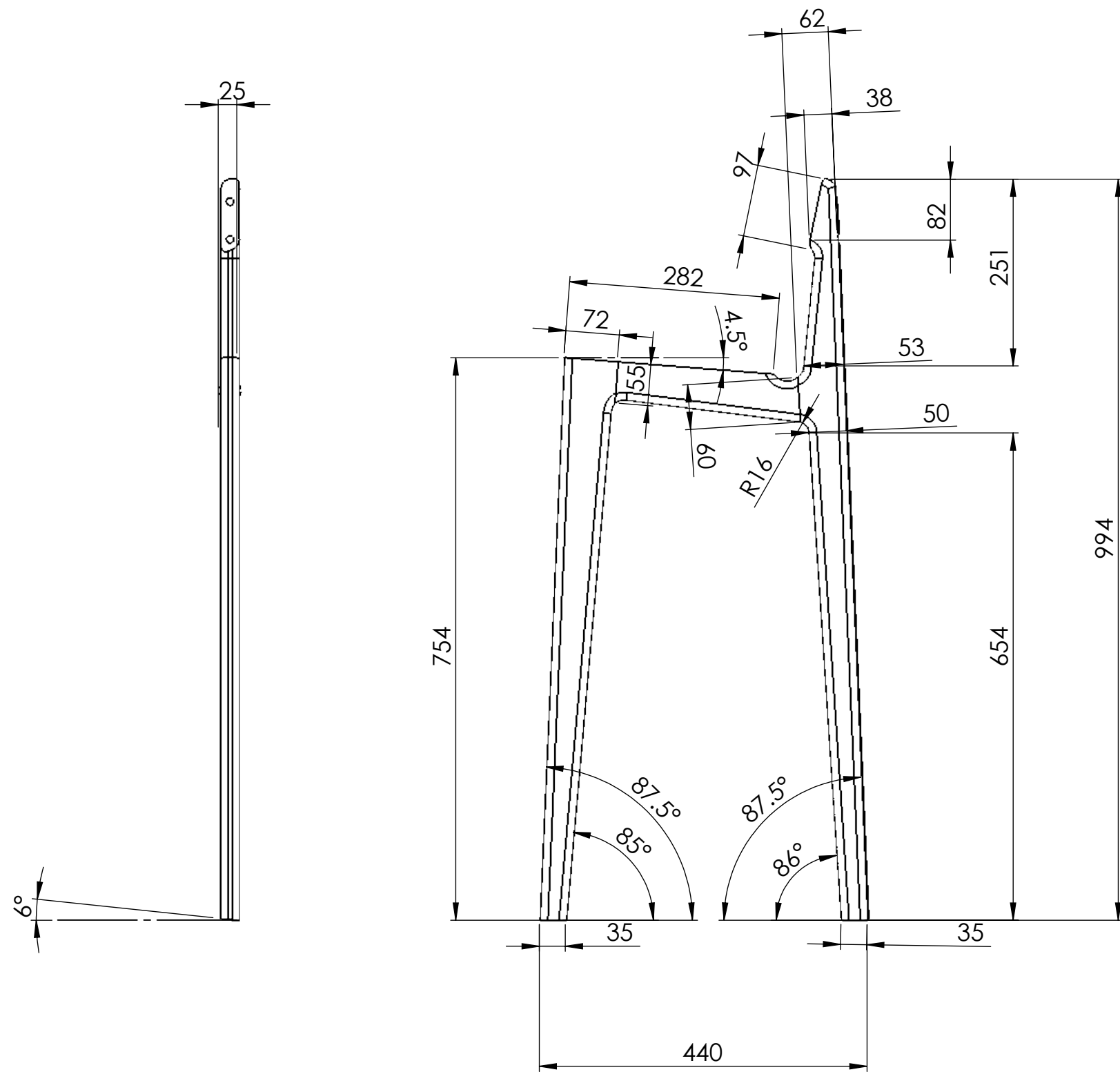

C13 - LATTE STOOL SUPPORTS

LED WIDTH RAILS - 1:4

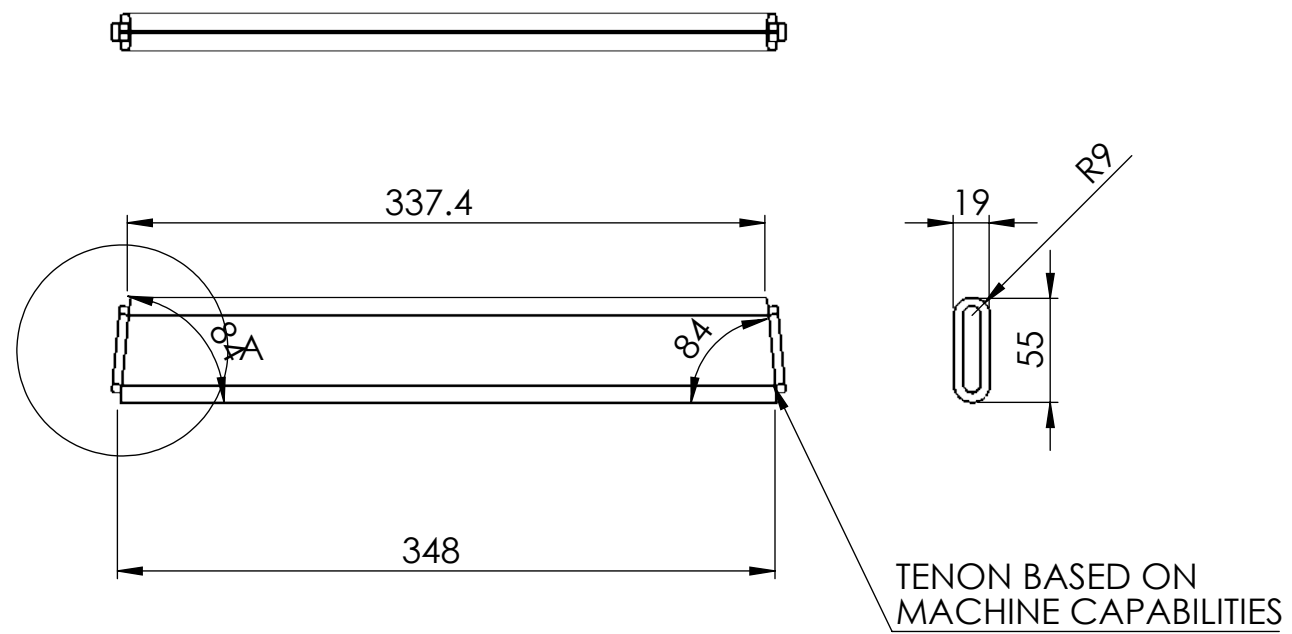

TENON JOINT EXAMPLE

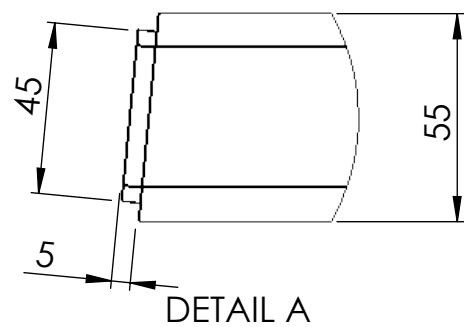

FRONT SEAT RAIL 1:4

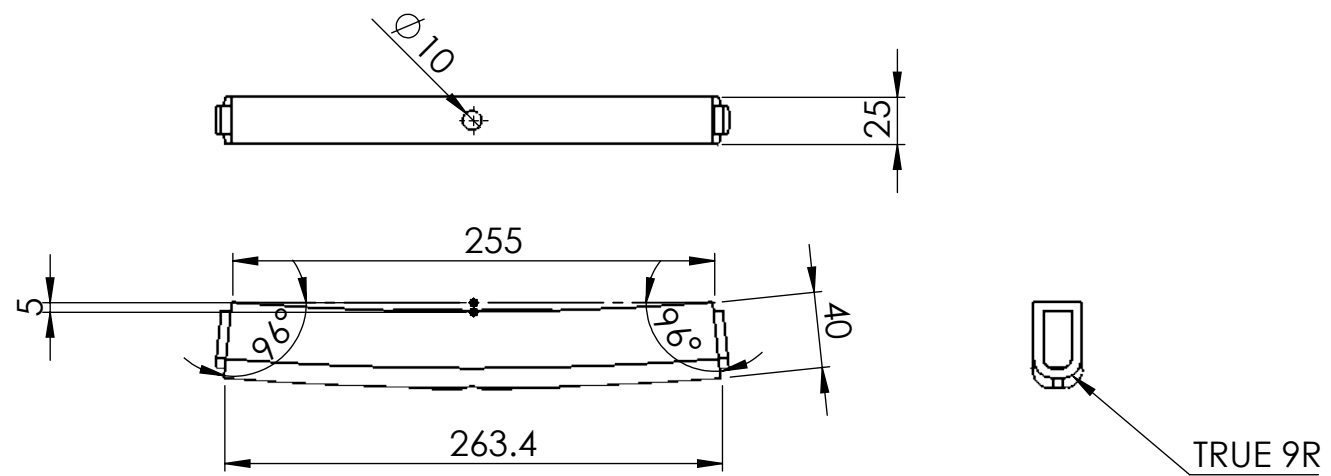

BACK SEAT RAIL 1:4

